

STODDARD COUNTY MISSOURI

PUBLISHED BY
W. W. HIXSON & CO. ROCKFORD ILLINOIS

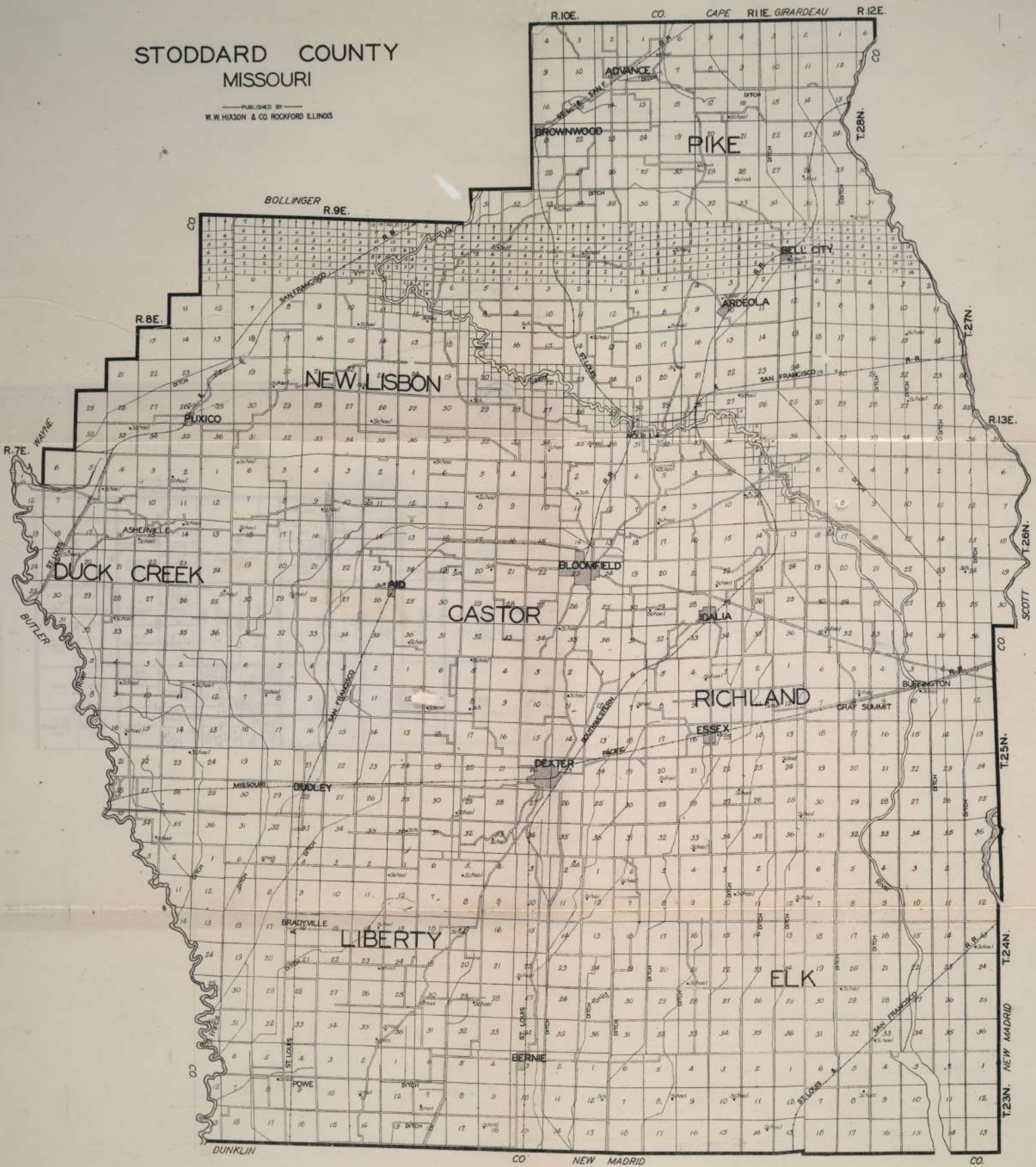

333, 09778

H 64
no. 103
RARE
Book
Room

Sta. Ag. 400
1.50
Hissan

T.23N.

R.12E.

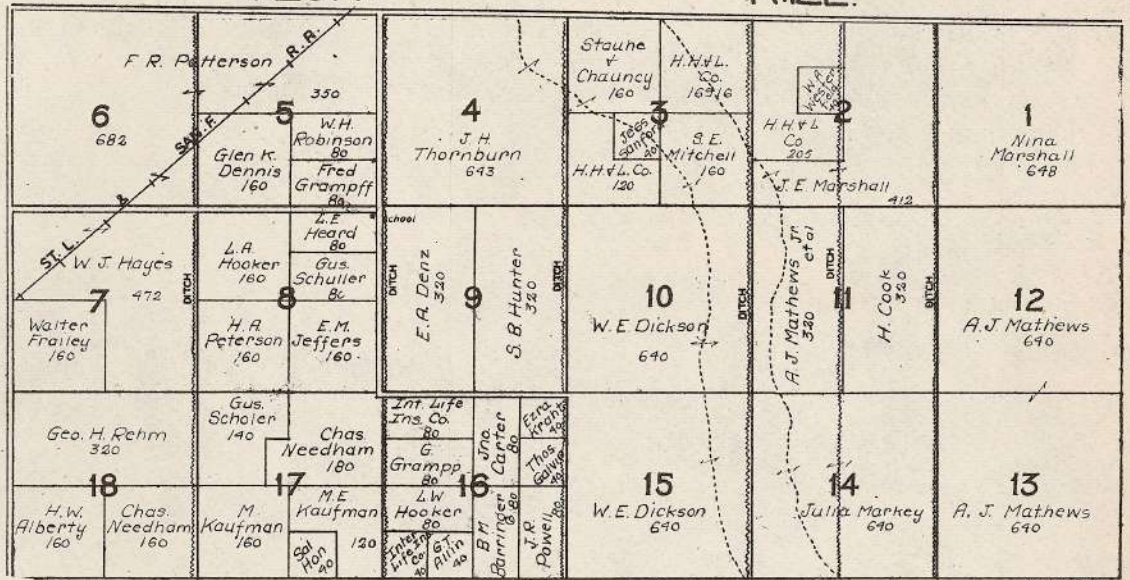

273947

T.24N.

R.12E

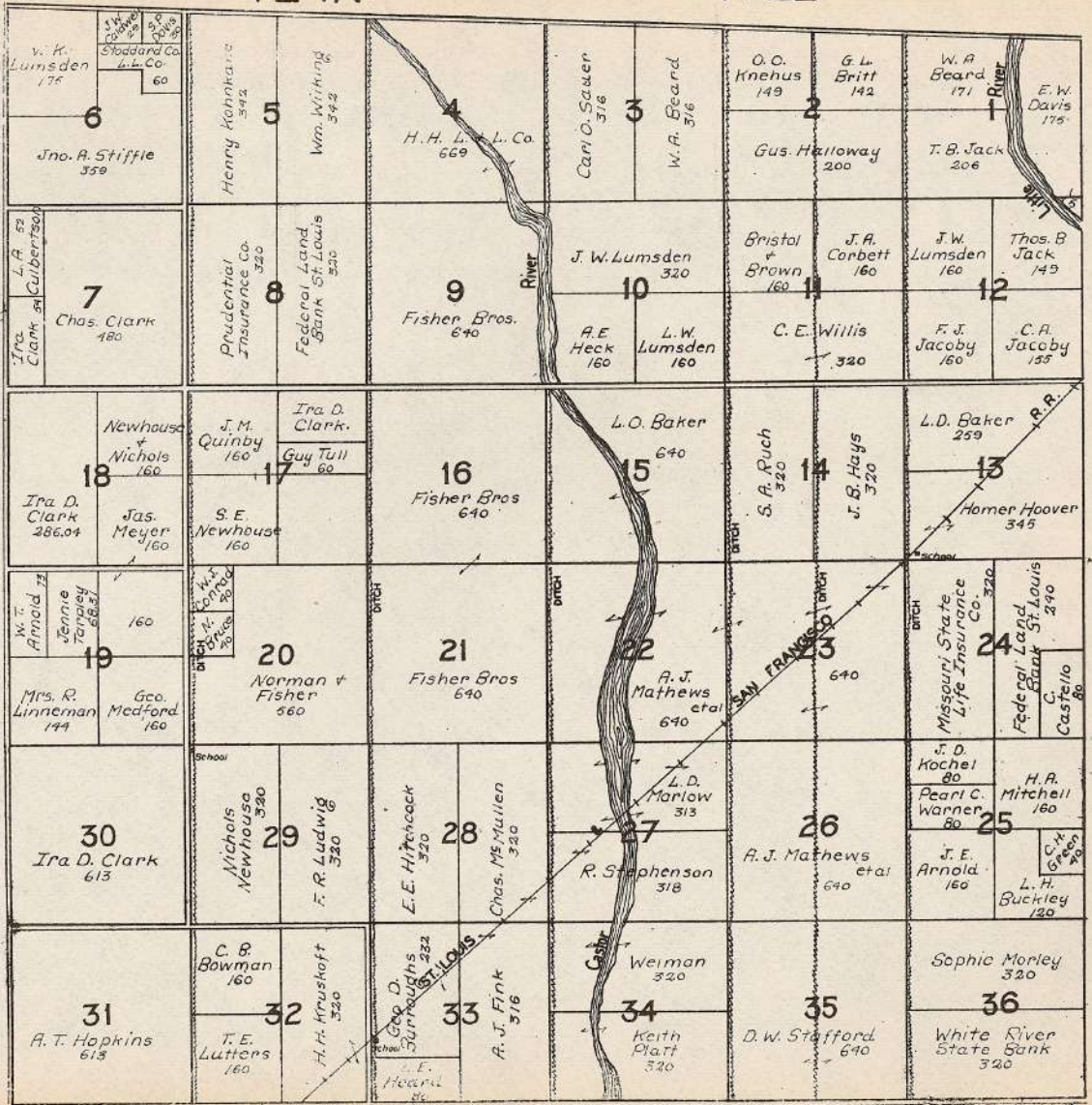

T.27N.

R.12&13E.

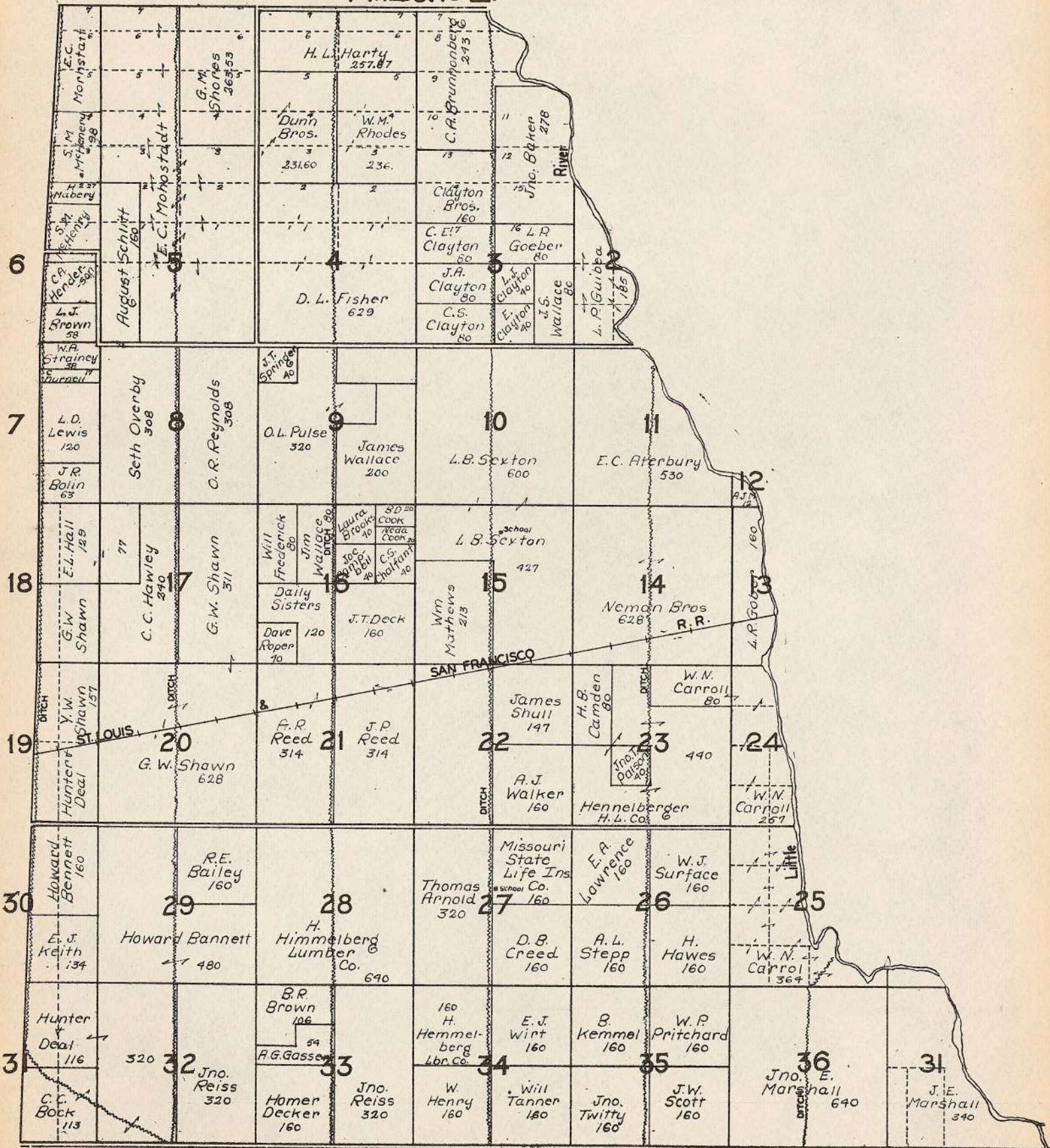

T.23N.

R.1E.

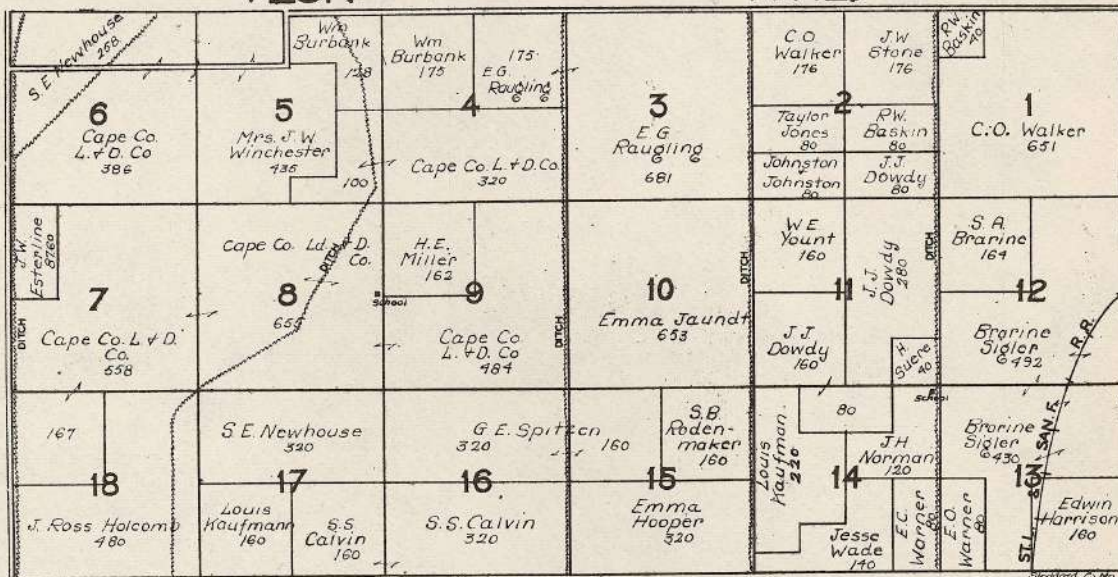

Standard Co. No.

T.24N.

R.1E.

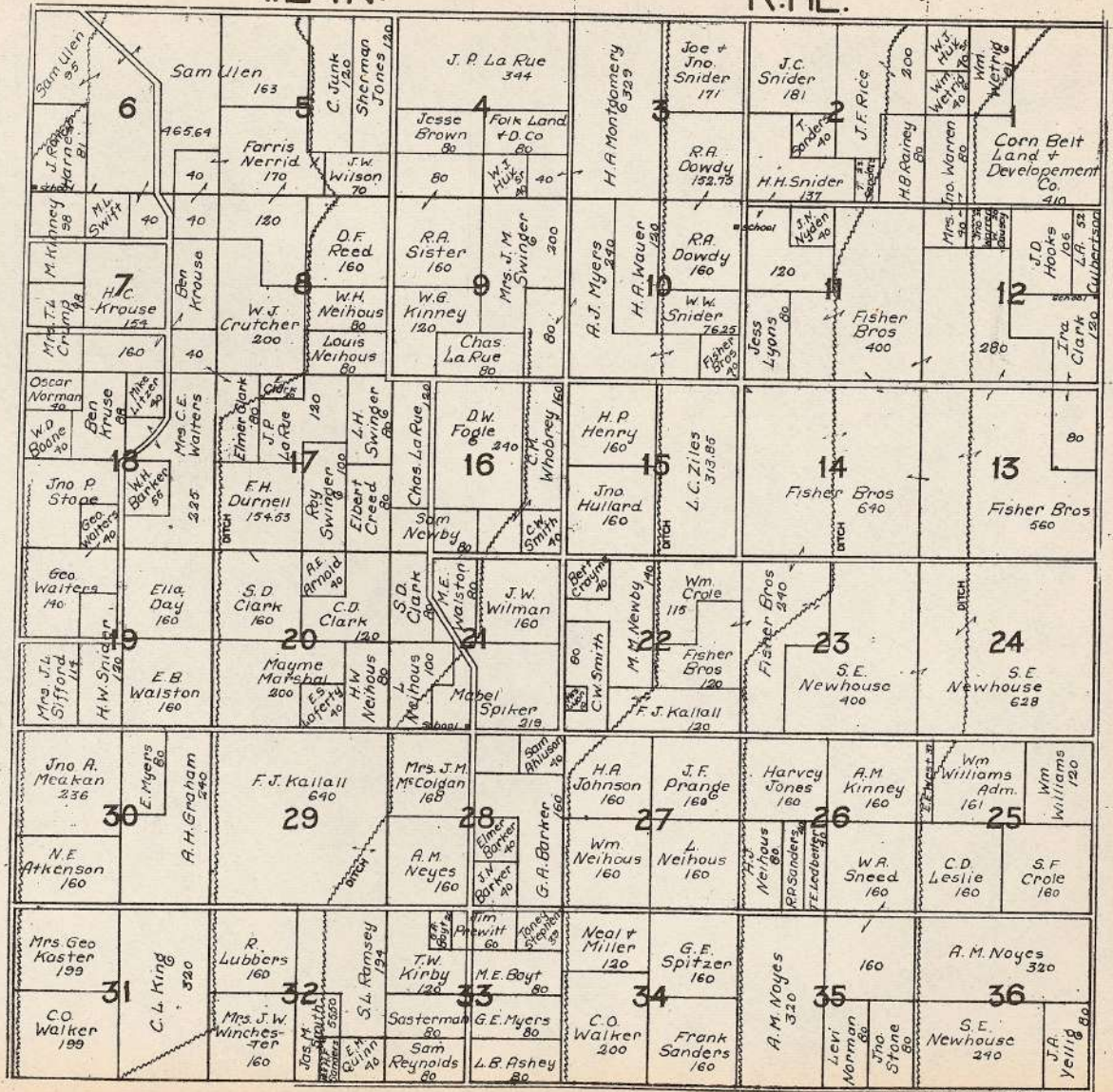

T.25N.

R.1E.

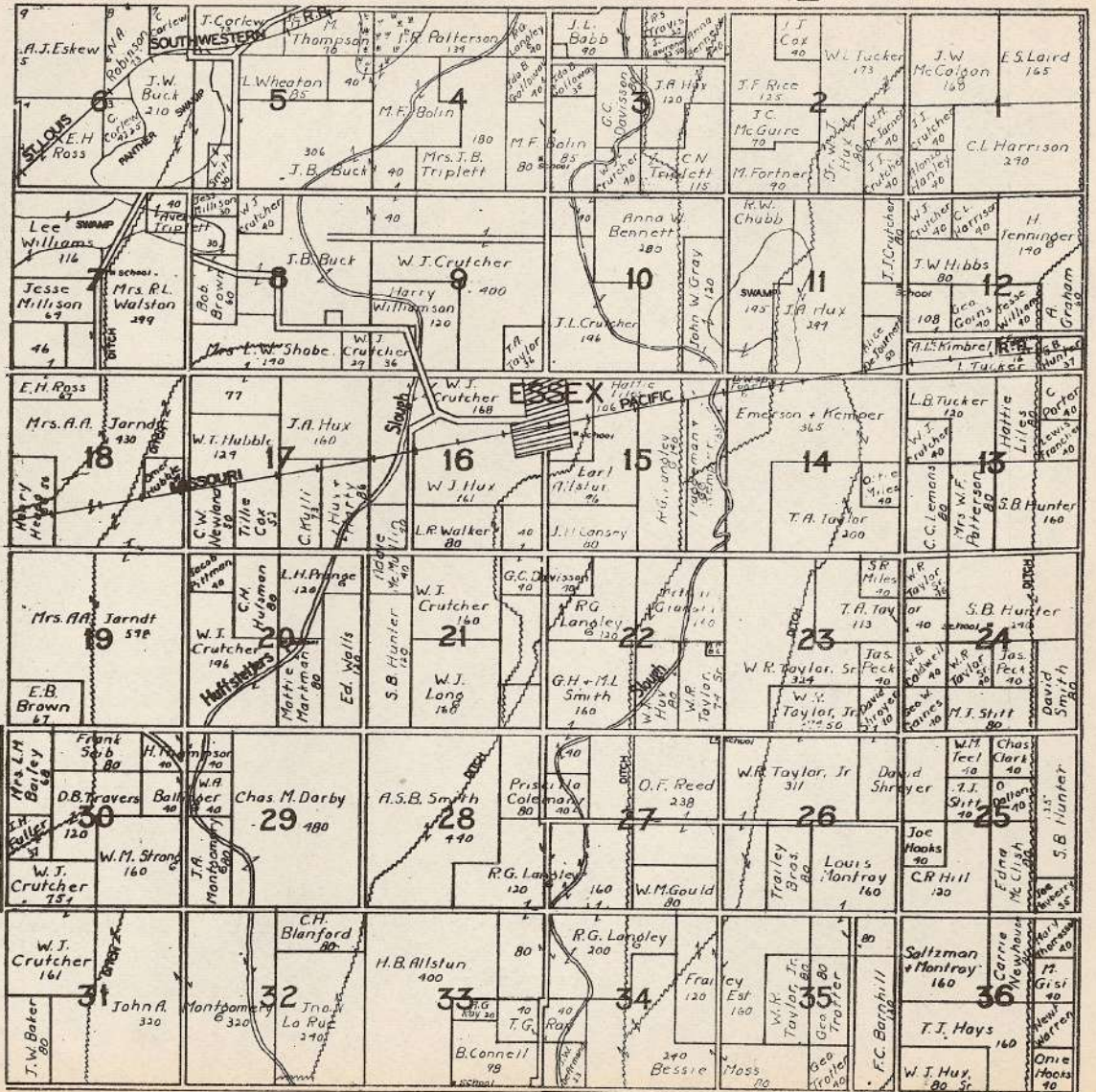

T.26N.

R.1E.

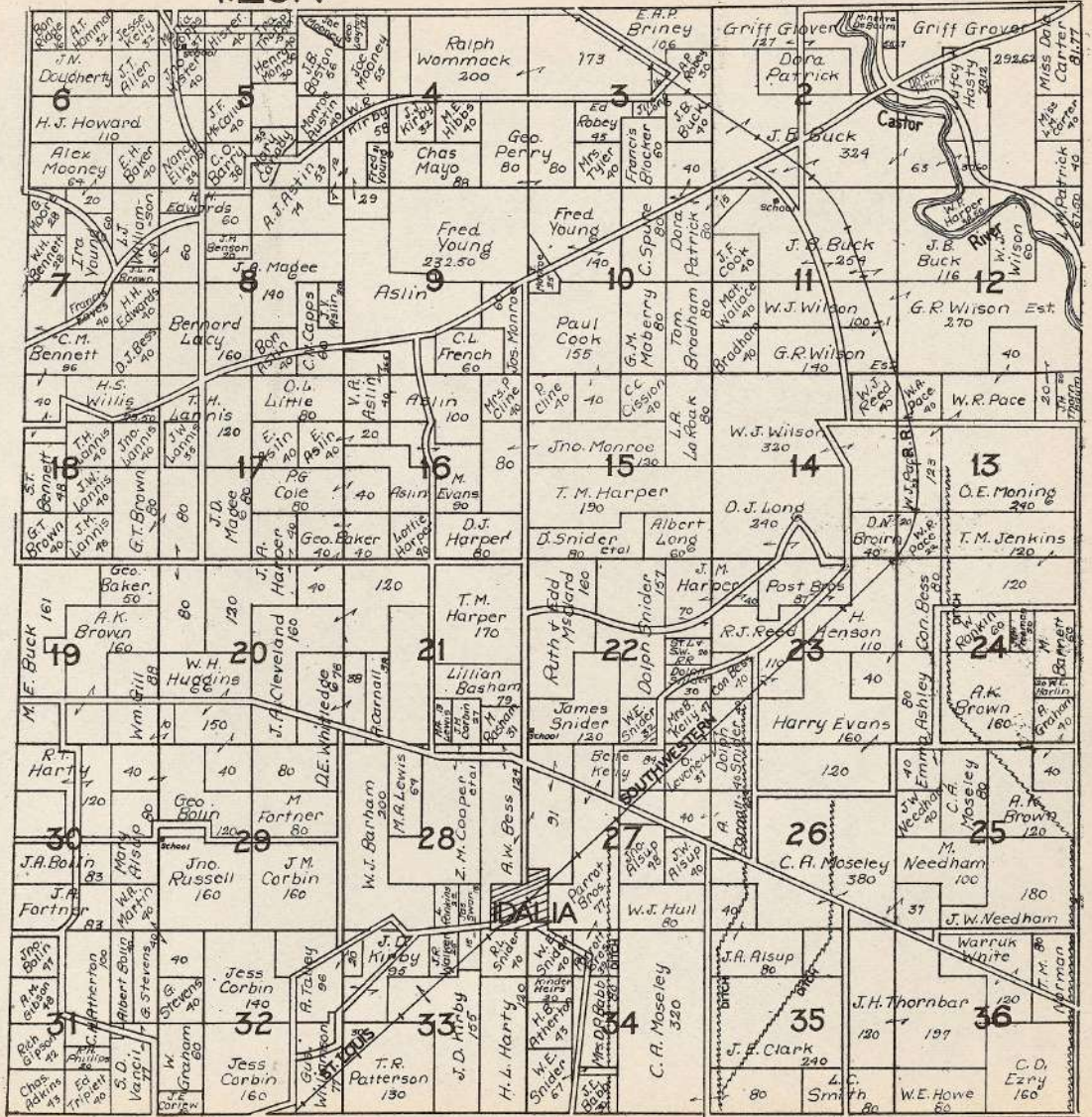

T.27N.

R.1E.

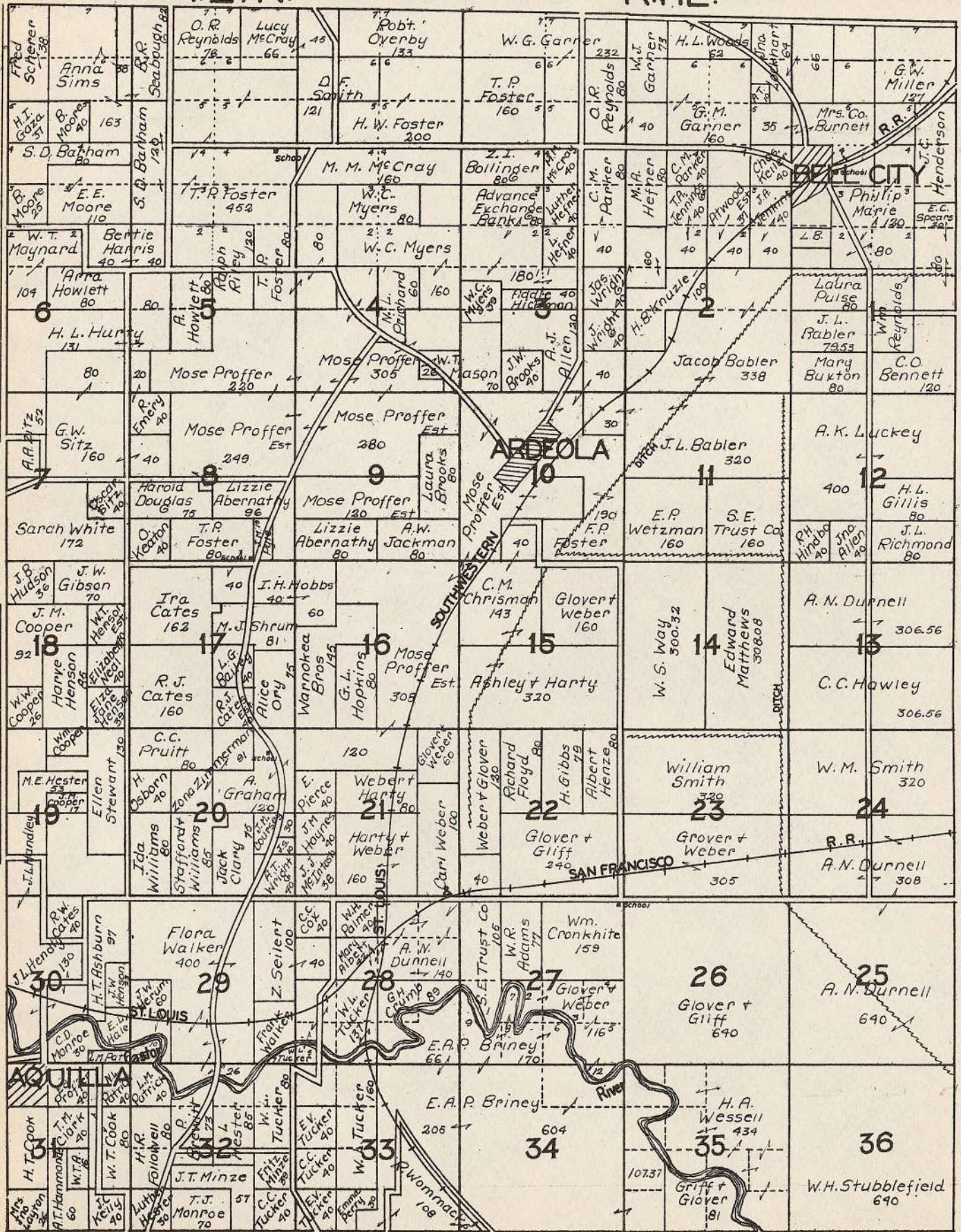

T.28N.

R.11&12E.

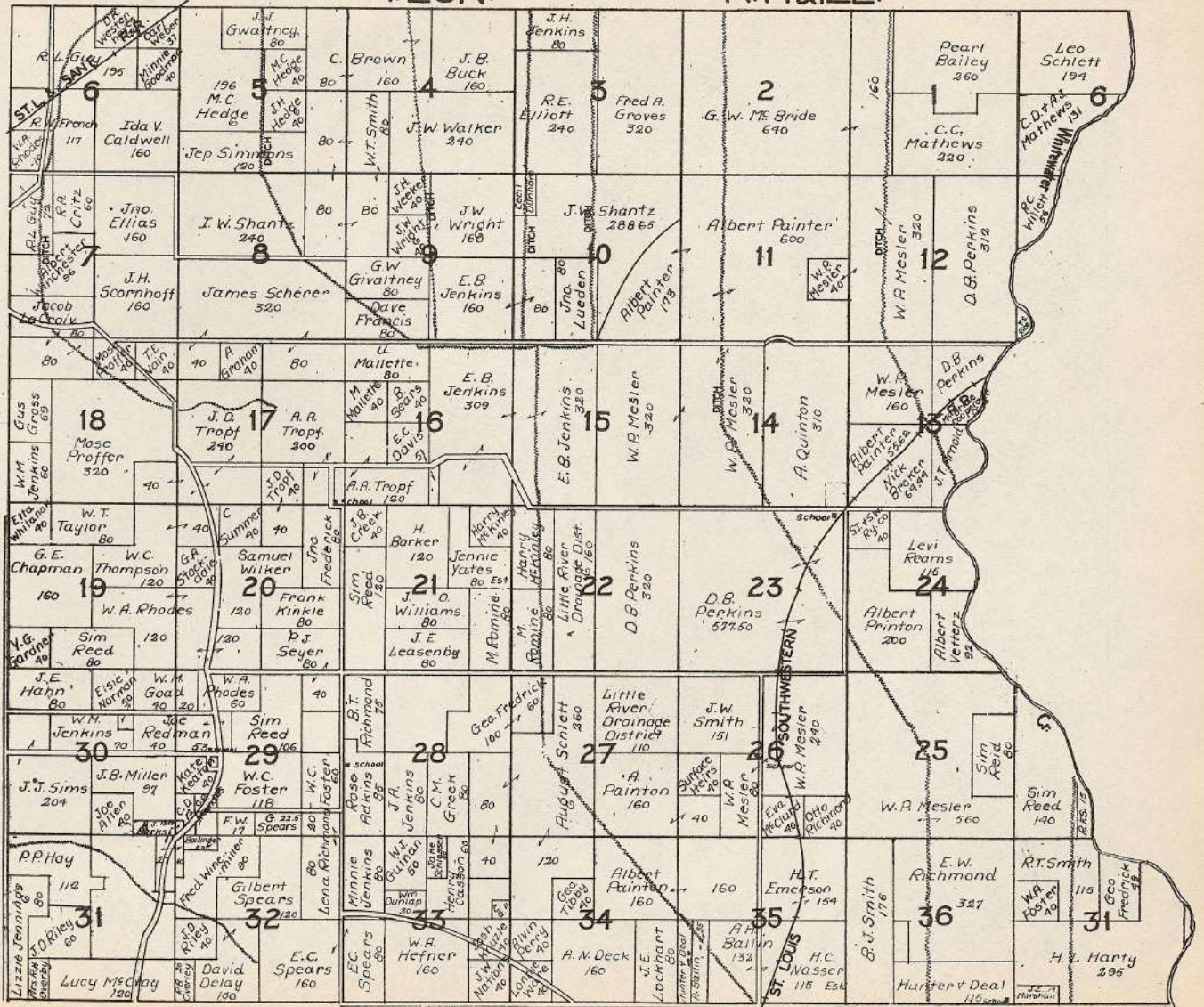

T.26N.

R.10E.

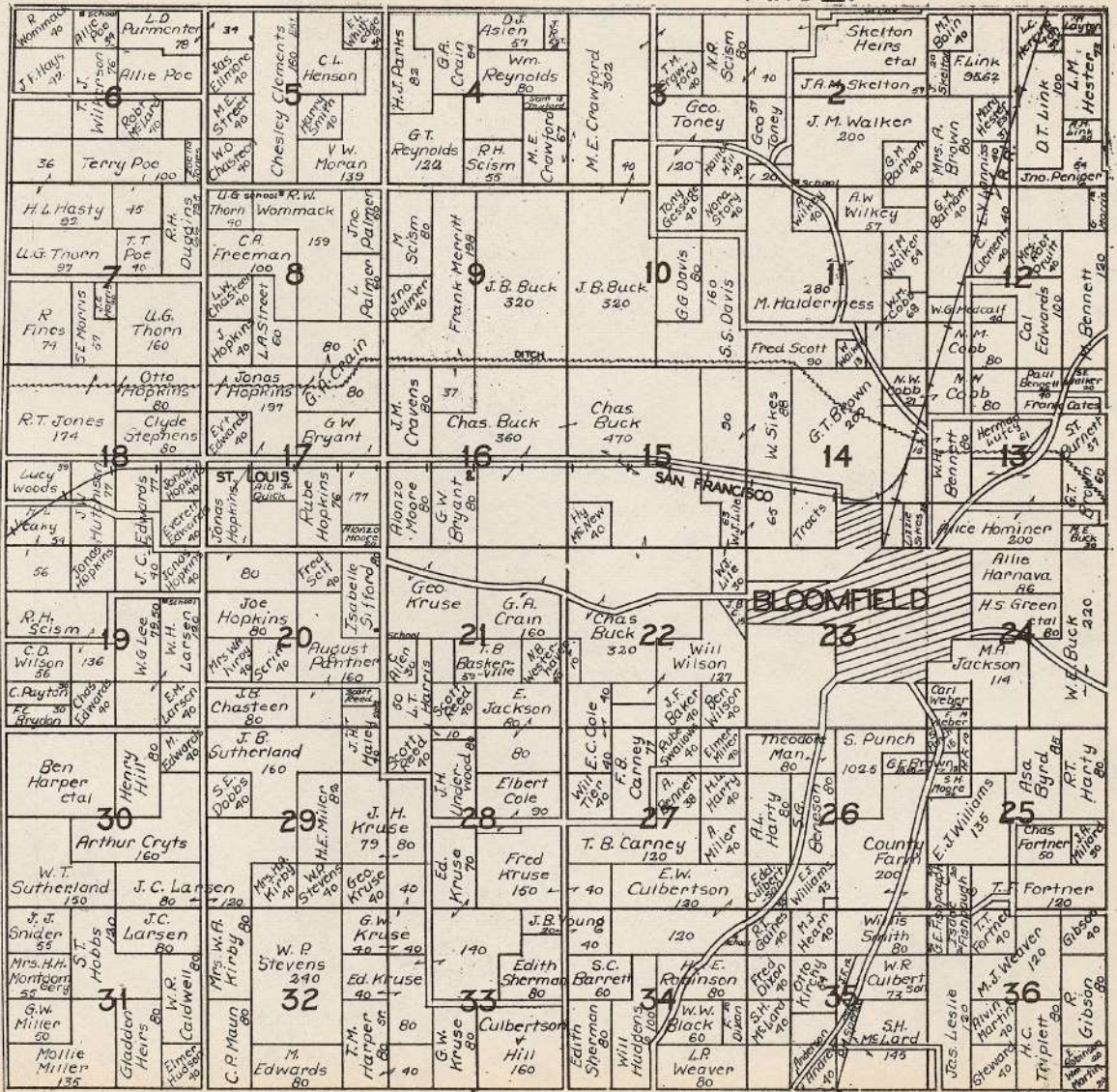

T.27N.

R.10E.

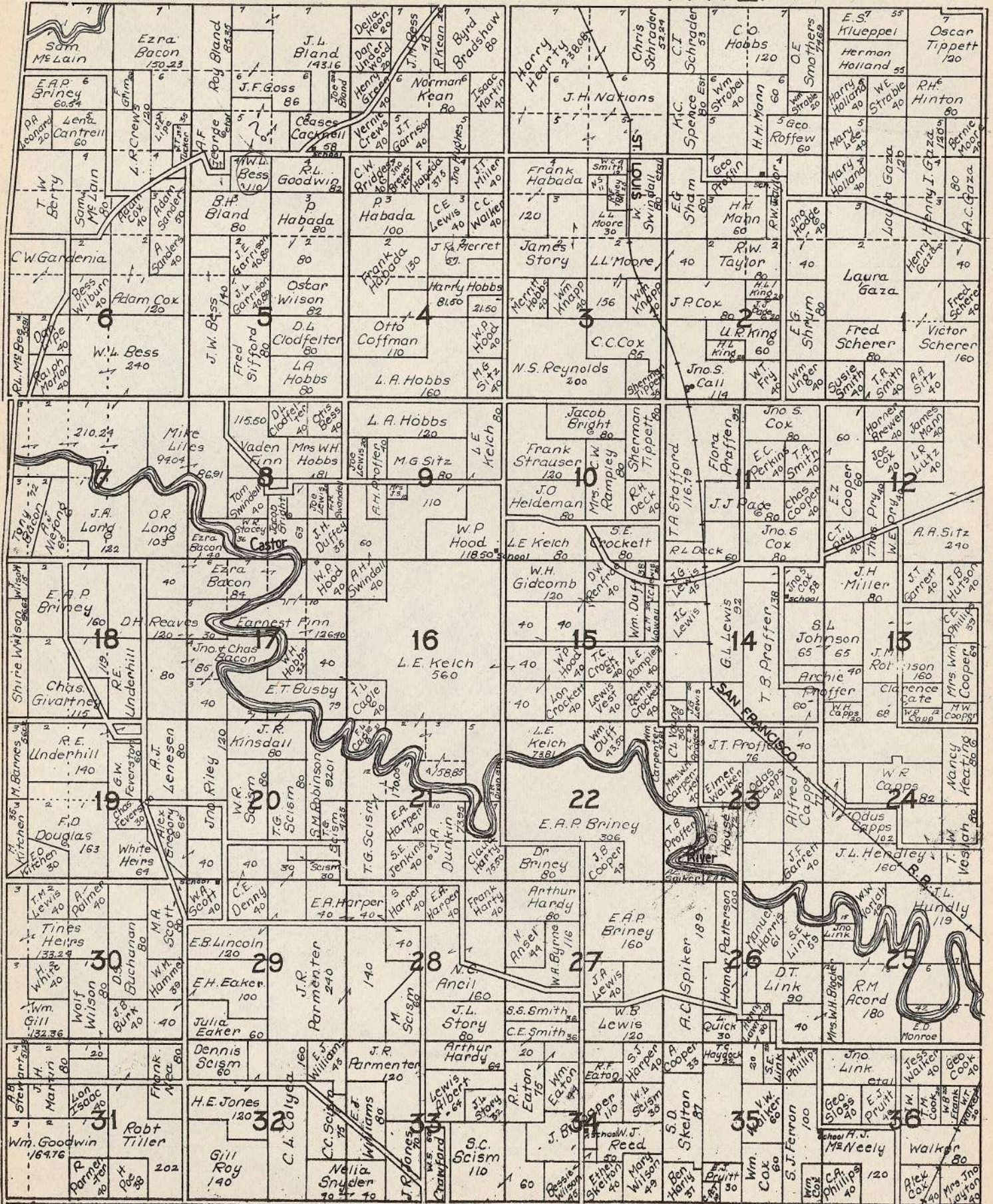

T.28N.

R.10E.

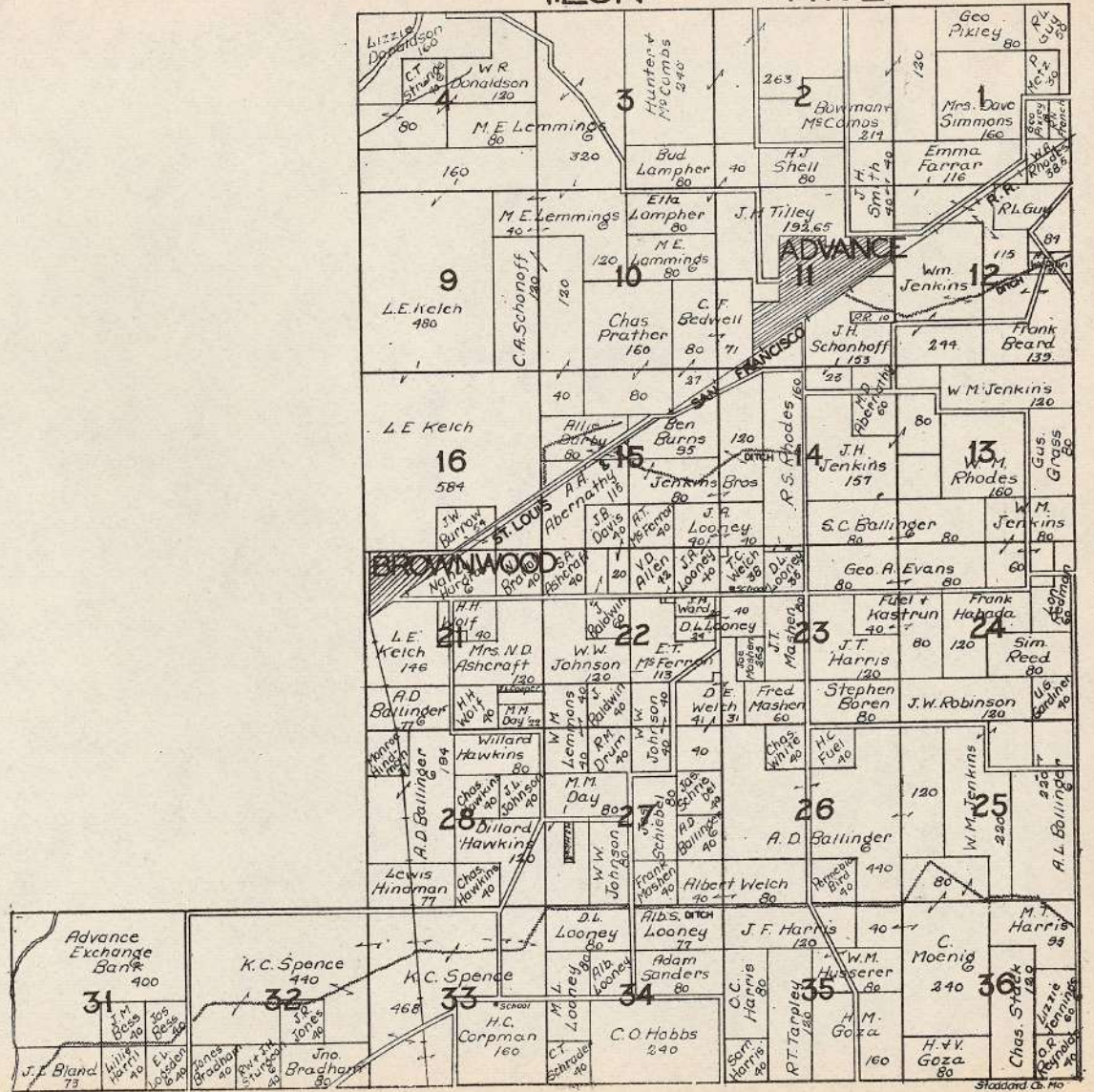

T.24N.

R.9E.

E.E. Mohrstadt 302		J.P. Hall Est. 344		Conn. Mutual Life Ins. Co. 1 235		Harry Houck 80		J.W. Jarrills 80		Chas. Temples 88		L.G. Dard 40		J.L. Dowdy 18	
F.B. Mitchell 144		Jno. Ehmon 80		C.R. Williams 233		J.W. Burison 80		S.W. Baldrige 80		D.L. Dowdy 78		Jas. Dowdy 40		L.G. Dard 40	
72		A.C. Spiker 40		Conn. Mutual Life Ins. Co. 540		Mrs. A. Morgan 160		Mrs. A. Morgan 160		D.L. Dowdy 78		J.A. Dowdy 60		R.A. Garner 80	
7		R.A. Ritter 80		9		J.E. Legande 80		Mrs. A. Morgan 160		11		W.C. Dickman 80		J.A. Dowdy 60	
Conn. Mutual Life Ins. Co. 240		Nancy Satterfield 80		Conn. Mutual Life Ins. Co. 400		M.J. Winton 60		R.R. Bockman 160		R.R. Bockman 160		W.C. Dickman 80		J.A. Dowdy 60	
Ed. Coman 40		Chas. Eddleman 80		Alonso Fields 40		Crutcher + Buck 222		W.T. Jonas 320		R.R. Bockman 160		Bloomfield Bank 160		J.A. Dowdy 60	
18		Conn. Mut. Life Ins. Co. 480		17		Conn. Mut. Life Ins. Co. 520		16		15		14		13	
19		Conn. Mutual Life Ins. Co. 640		20		Conn. Mutual Life Ins. Co. 640		21		22		23		24	
29		Conn. Mut. Life Ins. Co. 180		28		Conn. Mut. Life Ins. Co. 100		27		26		25		24	
31		Conn. Mutual Life Ins. Co. 600		32		Conn. Mut. Life Ins. Co. 640		33		34		35		36	
R. Micheal 235		J.L. Tyree 187		Otis Clark 115		A.H. Graham 333.52		Flanary Jones + Vaughn 320		J.C. Wilson 200		J.A. Blagg 80		J.J. Garrison 210	

T.26N.

R.9E.

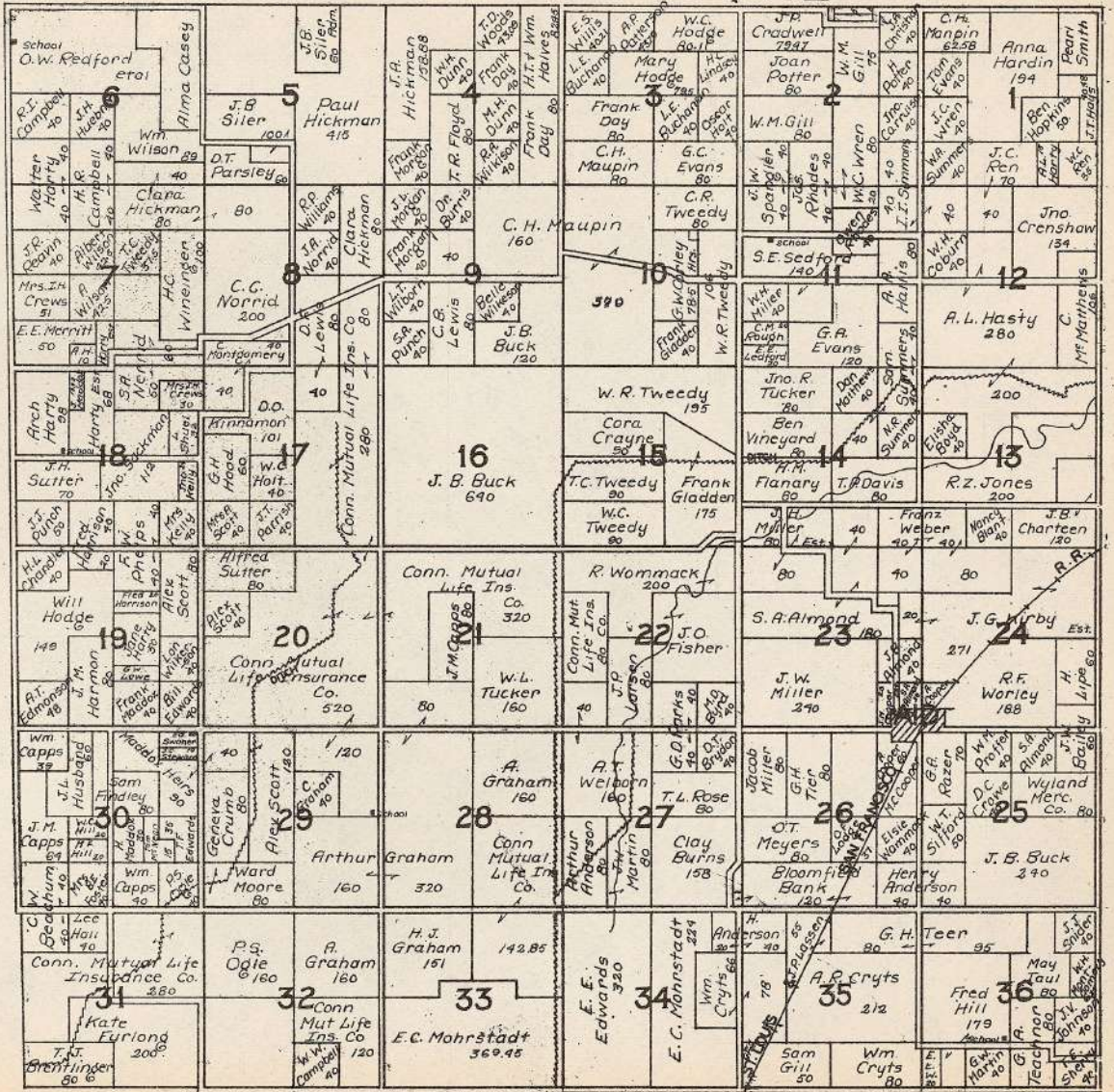

Sections 16 to 36

T.24N.

R.8E.

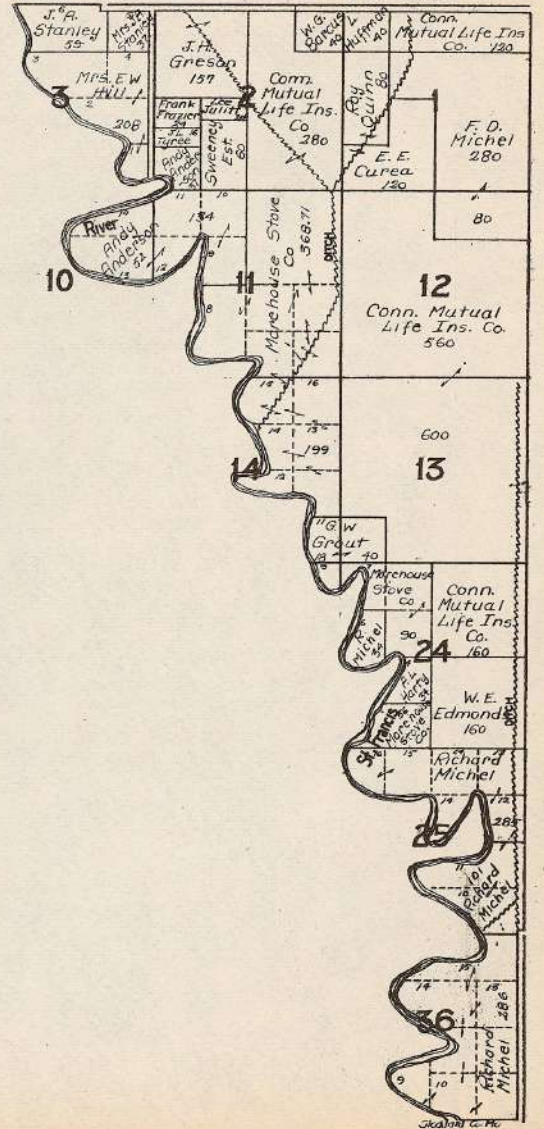

T.25N.

R.8E.

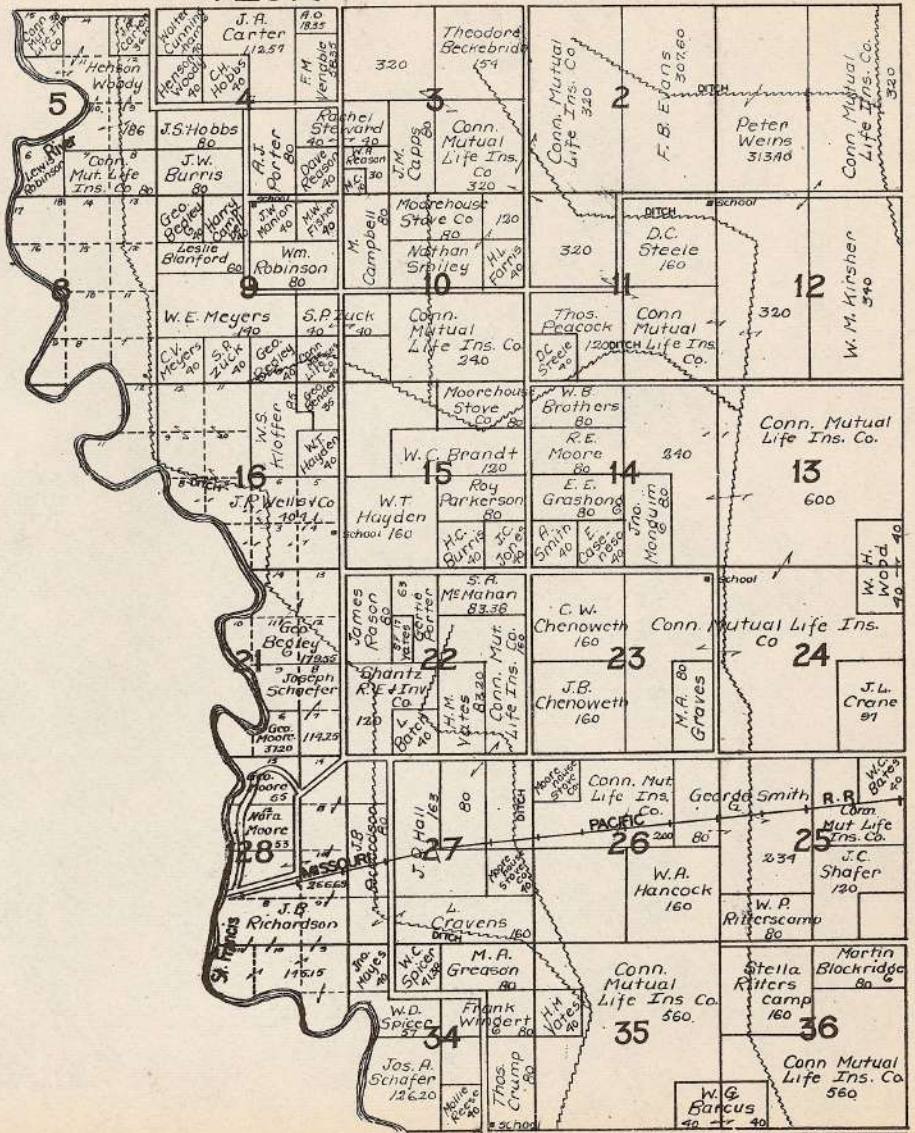

T.27N.

R.8E.

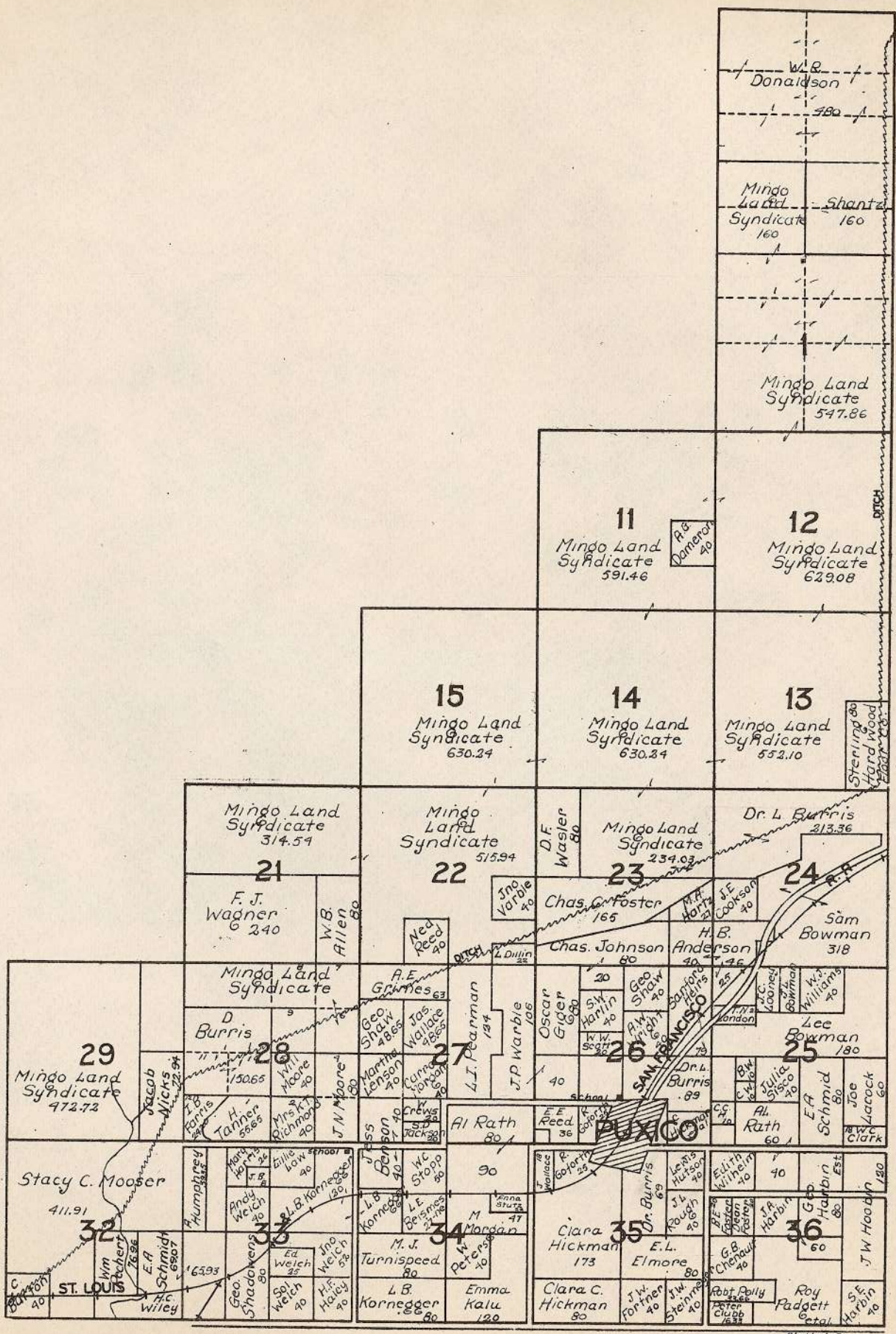

T.20N.

R.7&8E.

